

# DATA SHEET

**SIQUAL<sup>...</sup>**

7131

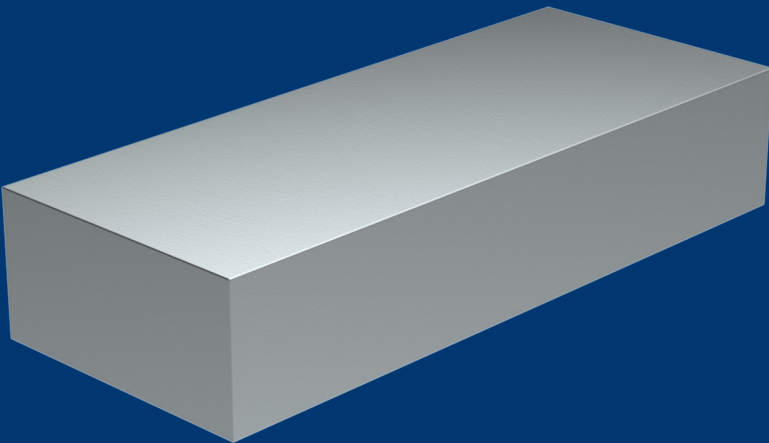

**W.NR.:** 1.7131 (EN ISO 4957)

**EN / DIN:** 16MnCr5

**AISI:** 5115, 5117

## CHEMICAL COMPOSITION

C	Si	Mn	Cr	Mo	Ni
0.16	Max 0.40	1.15	0.95	-	-

## DELIVERY CONDITION

soft annealed with a hardness of <207 HB

## PROCESS

conventional

## HEAT TREATMENT

<b>soft annealing</b> 650-700 °C	<b>cooling</b> furnace	<b>hardness (HB)</b> <207
<b>hardening</b> 860-980 °C	<b>quenching</b> oil, water, warm bath	<b>hardness (HRC)</b>

## PROPERTIES

Alloy, special carbon steel.

## APPLICATION

Steel suitable for carburising, cold shrinking.  
Suitable for the manufacture of gears, shafts,  
universal joints, etc.

### DISCLAIMER

The information and data presented herein are typical or average values and are not a guarantee of maximum or minimum values. Applications specifically suggested for material described herein are made solely for the purpose of illustration to enable the reader to make his own evaluation and are not intended as warranties, either express or implied, of fitness for these or other purposes. There is no representation that the recipient of this literature will receive updated editions as they become available.